

50314421P0

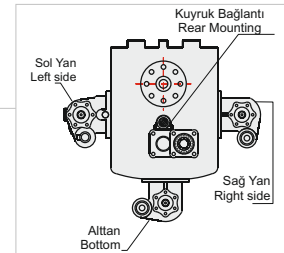
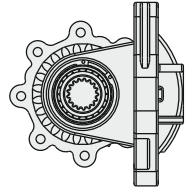
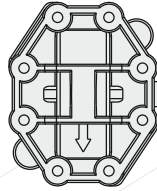
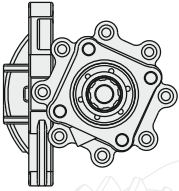
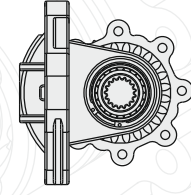
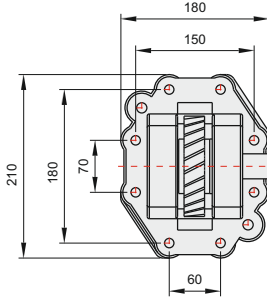
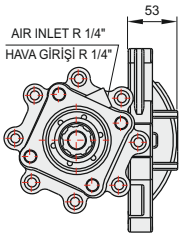
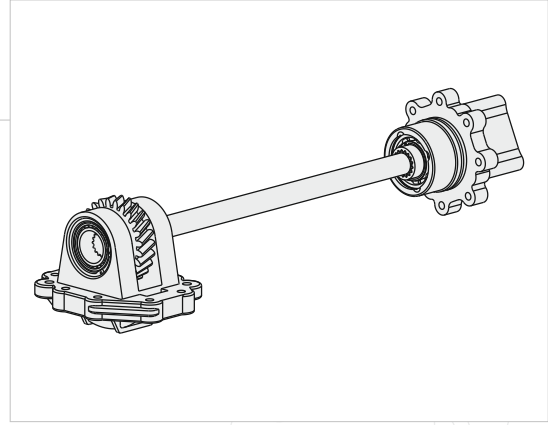

GENEL BİLGİLER/GENERAL DATA

P.T.O. KODU / P.T.O. CODE	50314421P0	
Tork / Torque	44,8 Kgm	436 Nm
Güç(1000 rpm) / Power	56,8Hp	42,4Kw
Devir / Speed	1250 rpm	1250 rpm
Oran / Ratio	1/1	1/1
Ağırlık / Weight	23,5 kg	51,8 lb
Bağlantı / Mounting	Kuyruk	Rear
Kumanda / Control	Havali	Pneumatic
Dönüş / P.T.O. Rotation	Sol - ISO	Left - ISO

Seçeğiniz pompanın dönüş yönü, P.T.O. dönüş yönü ile ters olmalıdır.
The rotation of the chosen pump has to be opposite with the rotation of P.T.O.

Ana Şanzıman / Gearbox	Kullanılan Bazı Araçlar / Used Vehicles
SCANIA GRSO 905	R420 / G 420 SCANIA

P.T.O. montaj edildikten sonra ana şanzıman yağını tamamlayın.
Fill the oil of the gear box after mounting the P.T.O.