



CNC 05-10-20 SERIES HYDRAULIC FILTER



SPECIFIC VALUES

Construction	Aluminium head Electrostatic dyed hair sleeve, (05 series Nylon 66 plastic sleeve)
Sealing	Nitrile
Max.Working Pressure	8 bar
Operating Temperature	-10°C~ +100°C
Fluid	Mineral Oils
Nominal Flow Rate	40~150 lt/min.
Bypass Opening Pressure	1,5 bar ± 0,3 bar
Filtration Range	25μ / 60μ (Consult for different μ)
Connection	G1/2"-G3/4"-G1"
Filtration Efficiency	98% for 25μ - 99% for 60μ

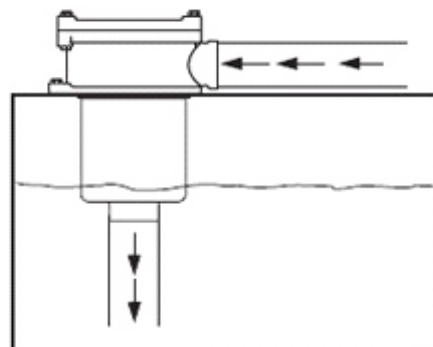
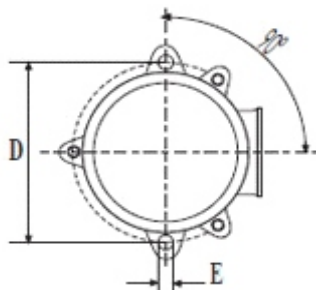
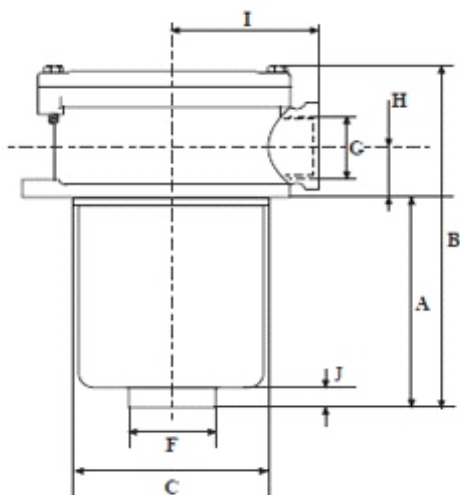



CODE	Nominal flow (p 0,25) lt/min.	G	A	B	C	D	E	F	H	I	J
CNC05-25	40	1/2"	88	140	66	90	7	24	22	51	24
CNC05-60	70	1/2"	88	140	66	90	7	24	22	51	24
CNC10-25	65	1/2"	103	172	87	115	9	1"	30	66	11
CNC10-60	115	1/2"	103	172	87	115	9	1"	30	66	11
CNC11-25	65	3/4"	103	172	87	115	9	1"	30	66	11
CNC11-60	115	3/4"	103	172	87	115	9	1"	30	66	11
CNC20-25	110	3/4"	136	205	87	115	9	1"	30	66	11
CNC20-60	150	3/4"	136	205	87	115	9	1"	30	66	11
CNC21-25	110	1"	136	205	87	115	9	1"	30	66	11
CNC21-60	150	1"	136	205	87	115	9	1"	30	66	11

FILTER ELEMENT	Filtration Range	K	L	Filtration Surface cm
CNE05-25	25μ	70	25	540
CNE05-60	60μ	70	25	330
CNE10-25	25μ	100	29	1250
CNE10-60	60μ	100	29	650
CNE20-25	25μ	130	29	1700
CNE20-60	60μ	130	29	840

